

Distributor



compomax

บริษัท คอมโพแม็ก จำกัด

CATALOGUE 2015-2016



- TERMINALS AND LUGS
- CRIMPING TERMINALS
- CABLE GLANDS
- CRIMPING TOOLS

CALL CENTER: 02 10 50 555
www.compomax.co.th

COMPANY PROFILE

บริษัท คอมโพลแม็กซ์ จำกัด ก่อตั้งขึ้นเมื่อปี พ.ศ. 2531 ดำเนินธุรกิจเกี่ยวกับการนำเข้าและจัดจำหน่ายอุปกรณ์ไฟฟ้าและอิเล็กทรอนิกส์ให้กับโรงงานอุตสาหกรรมต่างๆ เราจำหน่ายสินค้าคุณภาพสูง ทั้งยังเชี่ยวชาญในการให้คำปรึกษาด้านอุตสาหกรรมเพื่อเพิ่มความสามารถและประสิทธิภาพในการผลิต

เราจัดหาอุปกรณ์หลากหลายจากผู้ผลิตชั้นนำที่ได้รับการยอมรับและมีความเชี่ยวชาญที่สุดจาก ยุโรป อเมริกา และเอเชีย เพื่อความพึงพอใจและตอบสนองความต้องการของลูกค้าด้วยสินค้าที่มีคุณภาพ จึงไม่น่าแปลกใจที่อุปกรณ์ของเราได้รับการพิจารณาว่าเป็นสินค้าชั้นนำระดับโลกสำหรับการใช้เฉพาะทางในแต่ละอุตสาหกรรม

ด้วยประสบการณ์ที่สั่งสมมายาวนาน ทำให้คอมโพลแม็กซ์สามารถเข้าใจลึกซึ้งถึงความต้องการของลูกค้า ซึ่งความทุ่มเทในการทำงานเพื่อทำให้ลูกค้าพึงพอใจนี้ถือเป็นกุญแจสำคัญสู่ความสำเร็จของเรา



“เหนือกว่ารางวัลใดๆ คือความไว้วางใจของลูกค้า”

- » Automation
- » Process Control
- » Electrical Installation & Control
- » Power Distribution



ตัวแทนจำหน่ายอุปกรณ์ไฟฟ้า และอิเล็กทรอนิกส์ กว่า 100 แบรินด์ 20,000 รายการ



สนใจติดต่อ call center : 02 10 50 555 E-mail : sales@compomax.co.th





QUALITY FROM BEGINNING TO END

The BM headquarter is located at Rozzano, near Milan, and includes a highly automated production, packaging and distribution system for articles sent around the world. The continuous innovation of industrial processes has enabled us to manufacture high-quality products using integrated production cycles. That in turn has put us in a position in line with market expectations: our commitment has been recognised by Company Quality Certification in conformity with ISO 9001:2000, issued by the CSQ in May 1991, on the basis of strict international standards. Today, the goal we strive to achieve at company level remains that of guaranteeing ever better quality.

EXPERIENCE AND INNOVATION

With our heritage of experience and tradition and our natural inclination to innovate, we are preparing ourselves to tackle new challenges with the enthusiasm and professionalism that have characterised our work for over 50 years.

Our excellence can be demonstrated not only by the fact that every day thousands of professionals around the world choose to rely on our products, but also from the important recognition attributed us by organisations of international importance.

The professional X-pro scissors, recently launched on the market have received the Red Dot Design Award 2009, a prestigious award assigned by an international jury. The X-pro won thanks to its high level of design, ergonomics and ease of use, and it is demonstrative of the excellent level of quality achieved by our constant research activity.



TERMINALS AND LUGS

Nylon insulated crimping terminals and connectors	7
Uninsulated crimping terminals and connectors	10
End-sleeves	12
Low voltage copper tube nylon insulated terminals and connectors	13

CABLE GLANDS

Nylon cable glands and locknuts	24
Brass cable glands and locknuts	26

CRIMPING TOOLS

Crimping tools	28
Hand hydraulic presses	34

TOOLS

Cutting tools	35
---------------	----

CRIMPING TERMINALS

HOW A CABLE ENDS

The realization of electrical connections sometimes involves welding or laborious uptight operations in order to obtain a good end of the cable. But the complexity of such procedures can be avoided with appropriate connecting devices with features such as easy installation, low contact resistance, high global reliability and ease and speed of execution.

BM offers a wide range of crimping terminals, in which you can choose the most suitable products for each specific need, from copper tinned terminals, to brass tinned terminals (even uninsulated), to insulated terminals in PVC or nylon, to RJ plugs.

USE

BM proposal can solve any problem of wiring, thanks to the range that includes the size and characteristics of each terminal's elements (ring, conductor section, material, operating temperature, etc..) that fits best to each single installation, even the most burdensome.

The offer is complemented by the range of RJ plugs, for telephone and data networks, and by the sets of terminals and end-sleeves provided with crimping tools.

USEFUL INFORMATION

The purity of copper (99.9%) guarantees to terminals a high conductivity and high mechanical properties. Hot-treatment with forced ventilation and controlled temperature assures to BM terminals a greater malleability of the material during the crimping operation.

The surface treatment with processes of electrolytic and thickness tinning ensures the maximum adhesion of the tin to the terminal surface and allows to obtain a low contact resistance and a very high corrosion protection. Standard models are made of insulation in special self-extinguishing PVC or in Nylon. The colours used are according to international standards.

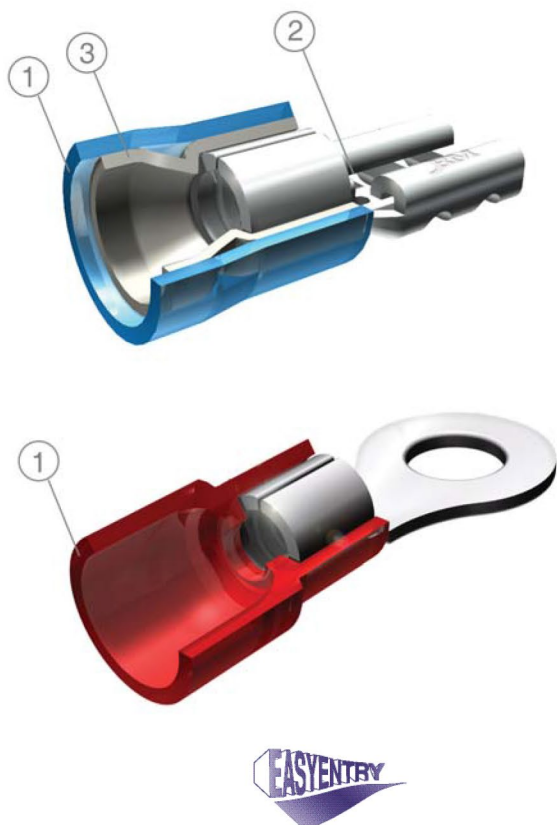

1 INSULATION EASY ENTRY SLEEVE

Self-extinguishing PVC according UL 94-V0

Temperature rating according UL 486A

Insulation nylon: 105°C

Moulded for copper terminals and shaped for disconnect terminals for an easy cable's insertion with no strand turn-back.

2 CABLE-STOP

3 COPPER SLEEVE EASY ENTRY

For quick wire insertions with no strand turn-back and a strong mechanical retention



RING

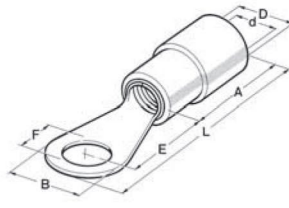

Type	Section mm ² (AWG)	For screw Ø mm Stud size	F	B	A	E	L	d	D	s	Tool	Packing pcs.
BM 80107	0,25 ÷ 1,5 (22-16)	3 # 4	3,20	8	10,4	8,6	22,2	1,95	4,20	0,8	536 1661 534 5341	1000
BM 80113		3,5 # 6	3,70	8	10,4	7,8	22,2	1,95	4,20	0,8		1000
BM 80119		4 # 8	4,30	7,4	10,4	6,5	20,8	1,95	4,20	0,8		1000
BM 80125		5 # 10	5,20	8	10,4	8	22,4	1,95	4,20	0,8		1000
BM 80131		6 # 12	6,20	10	10,4	8,6	23,7	1,95	4,20	0,8		1000
BM 80137		8 5/16	8,30	14	10,4	12,6	30	1,95	4,20	0,8		1000
BM 80143		10 3/8	10,40	14	10,4	12,8	30	1,95	4,20	0,8		1000
BM 80207	1,5 ÷ 2,5 (16-14)	3 # 4	3,20	8	11	8	23	2,45	4,80	0,8	536 1661 534 5341	1000
BM 80213		3,5 # 6	3,70	8	11	8	23	2,45	4,80	0,8		1000
BM 80219		4 # 8	4,30	8	11	6,5	21,5	2,45	4,80	0,8		1000
BM 80225		5 # 10	5,20	9	11	7,5	23,6	2,45	4,80	0,8		1000
BM 80231		6 # 12	6,20	10,5	11	9,8	26	2,45	4,80	0,8		1000
BM 80237		8 5/16	8,20	13	11	12,7	30	2,45	4,80	0,8		1000
BM 80243		10 3/8	10,50	15	11	14,5	33	2,45	4,80	0,8		1000
BM 80319	4 ÷ 6 (12-10)	4 # 8	4,20	8	14	8,4	26,5	3,50	6,60	1	536 1661 534 5341	500
BM 80325		5 # 10	5,20	10	14	8,5	27,5	3,50	6,60	1		500
BM 80331		6 # 12	6,20	11	14	11	30,6	3,50	6,60	1		500
BM 80337		8 5/16	8,20	15	14	15,3	37	3,50	6,60	1		500
BM 80343		10 3/8	10,50	19	14	16,5	40	3,50	6,60	1		500

FORK

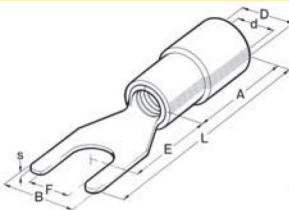

Type	Section mm ² (AWG)	For screw Ø mm Stud size	F	B	A	E	L	d	D	s	Tool	Packing pcs.
BM 80108	0,25 ÷ 1,5 (22-16)	3 # 4	3,20	5,6	10,4	6,7	20	1,95	4,20	0,8	536 1661 534 5341	1000
BM 80114		3,5 # 6	3,70	6,5	10,4	6,5	19,4	1,95	4,20	0,8		1000
BM 80120		4 # 8	4,20	6,4	10,4	6,3	20,9	1,95	4,20	0,8		1000
BM 80126		5 # 10	5,20	8	10,4	8	21,2	1,95	4,20	0,8		1000
BM 80132		6 # 12	6,20	9,2	10,4	8,3	22,4	1,95	4,20	0,8		1000
BM 80208	1,5 ÷ 2,5 (16-14)	3 # 4	3,20	5,6	11	8,4	23	2,45	4,80	0,8	536 1661 534 5341	1000
BM 80214		3,5 # 6	3,70	6,6	11	5,3	20,3	2,45	4,80	0,8		1000
BM 80220		4 # 8	4,20	6,6	11	5,3	20,3	2,45	4,80	0,8		1000
BM 80226		5 # 10	5,20	9,1	11	9,5	25	2,45	4,80	0,8		1000
BM 80232		6 # 12	6,30	10	11	11,2	27	2,45	4,80	0,8		1000
BM 80314	4 ÷ 6 (12-10)	3,5 # 6	3,70	8,1	14	7,2	26	3,50	6,60	1	536 1661 534 5341	500
BM 80320		4 # 8	4,20	8,1	14	7,2	26	3,50	6,60	1		500
BM 80326		5 # 10	5,20	9	14	10,5	28,5	3,50	6,60	1		500
BM 80332		6 # 12	6,30	11	14	11	29,5	3,50	6,60	1		500
BM 80338		8 5/16	8,20	15,2	14	15	35,2	3,50	6,60	1		500
BM 80344		10 3/8	10,50	19	14	16,6	38	3,50	6,60	1		500

Packing are intending multiple of 10 inner boxes.

ROUND PIN

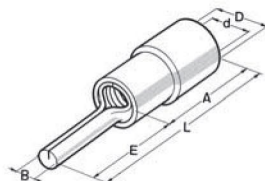

Type	Section mm ² (AWG)	B	E	A	L	d	D	Tool	Packing pcs.
BM 80150	0,25 ÷ 1,5 (22-16)	1,8	12	10,4	22	1,95	4,20	536 1661 534 5341	1000
BM 80250	1,5 ÷ 2,5 (16-14)	1,8	12	11	23	2,45	4,80		1000
BM 80350	4 ÷ 6 (12-10)	2,6	14	14	28	3,6	6,60		500

BUTT CONNECTOR INSULATED

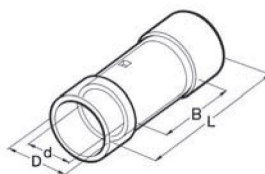

Type	Section mm ² (AWG)	B	L	d	D	Tool	Packing pcs.
BM 80160*	0,25 ÷ 1,5 (22-16)	15	26	1,8	4,2	536 1661 534 5341	1000
BM 80260*	1,5 ÷ 2,5 (16-14)	15	26	2,5	4,8		1000
BM 80360*	4 ÷ 6 (12-10)	15	27	3,7	6,5		500
BM 80460	10 (8)	26	43	4,8	8,2		500
BM 80560	16 (6)	29	46	6	9		182 100
BM 80660	25 (4)	29	46	7	11,5		100

UL LISTED file n° E 137735

THERMO-SHRINKABLE BUTT CONNECTOR

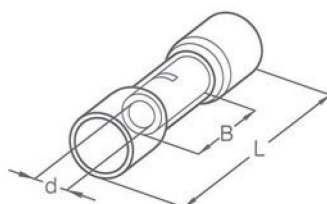

Connector material: Tinned copper
Insulation material: Thermo-shrinkable tubing with sealing adhesive
Shrinking temperature: 150 °C
Operating temperature: -55 °C +105 °C
Dielectric strength: 12 kV/mm - IEC 243

Type	Section mm ² (AWG)	B	L	d	Tool	Packing pcs.
BM 90160	0,5 ÷ 1,5 (20-16)	15	35	1,8	1108 534 5341	1000
BM 90260	1,5 ÷ 2,5 (16-14)	15	37	2,5		1000
BM 90360	4 ÷ 6 (12-10)	15	41	3,7		500

FEMALE TOTALLY INSULATED

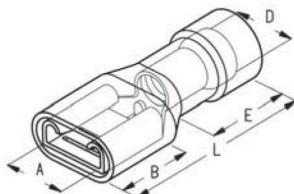

Type	Section mm ² (AWG)	For Male	A	B	E	L	D	Tool	Packing pcs.
		mm	Inch						
BM 80191	0,25 ÷ 1,5 (22-16)	6,3 x 0,8	0,250 x 0,032	6,6	7,8	11	22	3,8	1000
BM 80192		4,8 x 0,8	0,187 x 0,032	5	6,4	10,5	20,5	3,8	1000
BM 80193		4,8 x 0,5	0,187 x 0,020	5	6,4	10,5	20,5	3,8	1000
BM 80390		2,8 x 0,8	0,110 x 0,032	3,2	6	8,5	19,5	3,8	1000
BM 80395	1,5 ÷ 2,5 (16-14)	2,8 x 0,5	0,110 x 0,020	3,2	6	8,5	19,5	3,8	1000
BM 80291		6,3 x 0,8	0,250 x 0,032	6,6	7,8	11	22	4,5	500
BM 80292		4,8 x 0,8	0,187 x 0,032	5	6,4	10,5	20,5	4,5	1000
BM 80293		4,8 x 0,5	0,187 x 0,020	5	6,4	10,5	20,5	4,5	1000
BM 80392	4 ÷ 6 (12-10)	6,3 x 0,8	0,250 x 0,032	6,6	7,8	13	24	6	500

MALE TOTALLY INSULATED

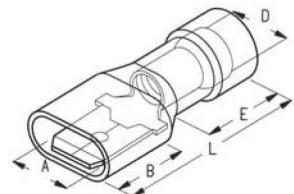

Type	Section mm ² (AWG)	Male	A	B	E	L	D	Tool	Packing pcs.
		mm	Inch						
BM 80180	0,25 ÷ 1,5 (22-16)	6,3 x 0,8	0,250 x 0,032	6,3	8	11	23	3,8	500
BM 80280	1,5 ÷ 2,5 (16-14)	6,3 x 0,8	0,250 x 0,032	6,3	8	11	23	4,5	500
BM 80380	4 ÷ 6 (12-10)	6,3 x 0,8	0,250 x 0,032	6,3	8	13	26	6	500

90° FEMALE

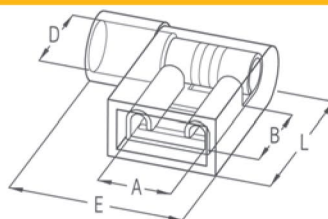

Type	Section mm ² (AWG)	For Male		A	B	L	D	E	Tool	Packing pcs.
		mm	Inch							
BM 80195*	0,5 ÷ 1,5 (20-16)	6,3 x 0,8	0,250 x 0,032	6,6	7,9	16	4	15	532	100
BM 80295*	1,5 ÷ 2,5 (16-14)	6,3 x 0,8	0,250 x 0,032	6,6	7,9	16	4,5	15	532	100

* Senza bussola in rame antivibrante / Without antivibration copper sleeve

BULLET

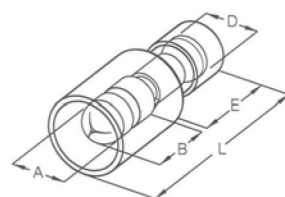

Type	Section mm ² (AWG)	A		B	E	L	D	Tool			Packing pcs.
		mm	Inch								
BM 80130	0,25 ÷ 1,5 (22-16)	4	0,156	9	11	24	4,2	536	1661	534	50
BM 80230	1,5 ÷ 2,5 (16-14)	5	0,195	9	11	24	4,8	536	1661	534	50

SOCKET

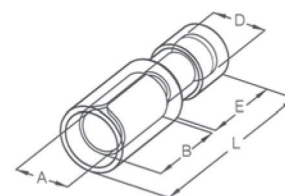

Type	Section mm ² (AWG)	A		B	E	L	D	Tool			Packing pcs.
		mm	Inch								
BM 80140	0,25 ÷ 1,5 (22-16)	4	0,156	9	11	23	4,2	536	1661	534	50
BM 80240	1,5 ÷ 2,5 (16-14)	5	0,195	9	11	23	4,8	536	1661	534	50

RING



Type	Section mm ² (AWG)	For screw Ø mm Stud size	F	B	L	d	A	Tool	Packing pcs.
BM 01101	0,25 ÷ 1,5 (22-16)	2,5 # 3	2,60	8	17,25	1,95	5,20	524 1661 522 535 5351	2000
BM 01107		3 # 4	3,20	8	17,25	1,95	5,20		2000
BM 01113		3,5 # 6	3,70	8	17,25	1,95	5,20		2000
BM 01119		4 # 8	4,30	7,4	15,4	1,95	5,20		2000
BM 01125		5 # 10	5,20	8,5	17,45	1,95	5,20		2000
BM 01131		6 # 12	6,20	10	18,5	1,95	5,20		2000
BM 01137		8 5/16	8,20	14	25	1,95	5,20		2000
BM 01143		10 3/8	10,50	14	25	1,95	5,20		2000
BM 01201	1,5 ÷ 2,5 (16-14)	2,5 # 3	2,60	8	17,25	2,45	5,20	524 1661 522 535 5351	2000
BM 01207		3 # 4	3,20	8	17,25	2,45	5,20		2000
BM 01213		3,5 # 6	3,70	8	17,25	2,45	5,20		2000
BM 01219		4 # 8	4,30	8	15,7	2,45	5,20		2000
BM 01225		5 # 10	5,20	9	17,2	2,45	5,20		2000
BM 01231		6 # 12	6,20	10,5	20,3	2,45	5,20		2000
BM 01237		8 5/16	8,20	13	24,4	2,45	5,20		2000
BM 01243		10 3/8	10,50	15	26,8	2,45	5,20		2000
BM 01313	4 ÷ 6 (12-10)	3,5 # 6	3,70	8	18,7	3,50	6,50	524 1661 522 535 5351	1000
BM 01319		4 # 8	4,20	8	18,7	3,50	6,50		1000
BM 01325		5 # 10	5,20	10	20	3,50	6,50		1000
BM 01331		6 # 12	6,20	11	23	3,50	6,50		1000
BM 01337		8 5/16	8,20	15	29,3	3,50	6,50		1000
BM 01343		10 3/8	10,50	19	32	3,50	6,50		1000





FORK



Type	Section mm ² (AWG)	For screw Ø mm Stud size	F	B	L	d	A	Tool	Packing pcs.
BM 01102	0,25 ÷ 1,5 (22-16)	2,5 # 3	2,60	5,60	14,60	1,95	5,20	524 1661 522 535 5351	2000
BM 01108		3 # 4	3,20	5,60	14,60	1,95	5,20		2000
BM 01114		3,5 # 6	3,70	6,50	14,90	1,95	5,20		2000
BM 01120		4 # 8	4,20	6,50	15,70	1,95	5,20		2000
BM 01126		5 # 10	5,20	8,00	16,25	1,95	5,20		2000
BM 01132		6 # 12	6,20	9,20	17,50	1,95	5,20		2000
BM 01202	1,5 ÷ 2,5 (16-14)	2,5 # 3	2,60	5,60	17,25	2,45	5,20	524 1661 522 535 5351	2000
BM 01208		3 # 4	3,20	5,60	17,25	2,45	5,20		2000
BM 01214		3,5 # 6	3,70	6,50	14,30	2,45	5,20		2000
BM 01220		4 # 8	4,20	6,50	15,70	2,45	5,20		2000
BM 01226		5 # 10	5,20	9,10	19,25	2,45	5,20		2000
BM 01232		6 # 12	6,20	10	21	2,45	5,20		2000
BM 01314	4 ÷ 6 (12-10)	3,5 # 6	3,70	8	19,65	3,50	6,50	524 1661 522 535 5351	1000
BM 01320		4 # 8	4,20	8	18,60	3,50	6,50		1000
BM 01326		5 # 10	5,20	9	21,10	3,50	6,50		1000
BM 01332		6 # 12	6,20	11	22,30	3,50	6,50		1000
BM 01338		8 5/16	8,20	15,20	27,50	3,50	6,50		1000
BM 01344		10 3/8	10,25	19	30,20	3,50	6,50		1000





PIN



Type	Section mm ² (AWG)	A	B	E	L	d	Tool	Packing pcs.
BM 01150	0,25 ÷ 1,5	1,8	12	5,2	17,3	1,85	    	2000
BM 01151	(22-16)	1,8	9	5,2	14,2	1,85		2000
BM 01250	1,5 ÷ 2,5	1,8	12	5,2	17,3	2,40		2000
BM 01251	(16-14)	1,8	9	5,2	14,2	2,40		2000
BM 01350	4 ÷ 6 (12-10)	2,6	12,5	6,5	20,5	3,60		1000

BUTT CONNECTOR



Type	Section mm ² (AWG)	B	L	d	Tool	Packing pcs.
BM 01160	0,25 ÷ 1,5 (22-16)	3,3	15,0	1,8	    	2000
BM 01260	1,5 ÷ 2,5 (16-14)	4,1	15,0	2,5		2000
BM 01360	4 ÷ 6 (12-10)	5,5	15,0	3,7		1000

PARALLEL CONNECTOR



Type	Section mm ² (AWG)	B	L	d	Tool	Packing pcs.
BM 01162	0,25 ÷ 1,5 (22-16)	3,3	8	1,8	    	2000
BM 01262	1,5 ÷ 2,5 (16-14)	4,1	8	2,5		2000
BM 01362	4 ÷ 6 (12-10)	5,5	8,5	3,7		1000

UNINSULATED

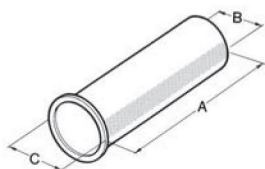

Type	Section mm ² (AWG)	A	B	C	Tool	Packing pcs.
BM 01501	0,5 (22)	6	1,0	2,1		1000
BM 01502	0,75 (20)	6	1,2	2,3		1000
BM 01503	1,0 (18)	10	1,4	2,5		1000
BM 01504	1,5 (16)	7	1,7	2,8		1000
BM 01505	1,5 (16)	10	1,7	2,8		1000
BM 01506	2,5 (14)	7	2,2	3,4		1000
BM 01507	2,5 (14)	12	2,2	3,4		1000
BM 01508	4 (12)	9	2,8	4,0		500
BM 01509	4 (12)	12	2,8	4,0		500
BM 01510	6 (10)	12	3,5	4,7		250
BM 01511	6 (10)	15	3,5	4,7		250
BM 01512	10 (8)	15	4,5	5,8		250
BM 01513	10 (8)	18	4,5	5,8		200
BM 01514	16 (6)	15	5,8	7,5		100
BM 01515	16 (6)	18	5,8	7,5		250
BM 01516	25 (4)	18	7,3	9,5		250
BM 01517	35 (2)	18	8,3	11,0		50
BM 01518	50 (1)	22	10,3	13,0		100
BM 01519	70 (2/0)	25	12,5	13,5		100
BM 01520	95 (3/0)	25	14,5	17,5		100
BM 01521	120 (4/0)	30	17,0	19,5		100

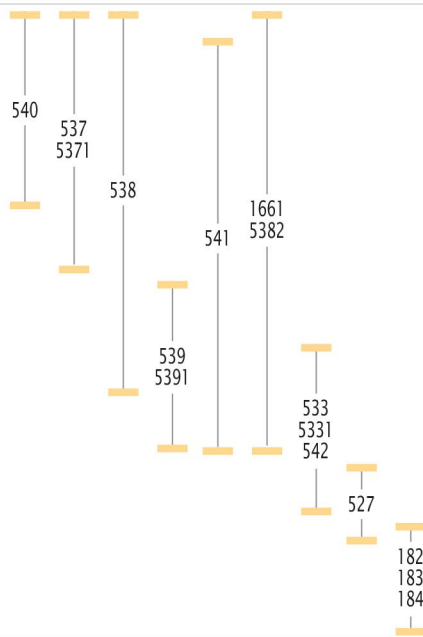

SINGLE CABLE

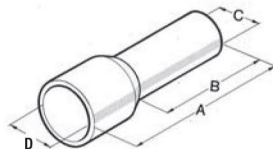

Standard color 1		Standard color 2		Color DIN 46228/4		Section mm² (AWG)	A	B	C int.	D	Tool	Packing pcs.
Type	Color	Type	Color	Type	Color							
BM 005001	grigio/grey					0,14 (26)	12	8	0,7	1,6		5000
BM 00500	azzurro/light blue					0,25 (24)	12	8	0,75	1,8		5000
BM 005002	turchese/turque					0,34 (24)	12	8	0,8	2		5000
BM 00501	arancio/orange	BM 00601	bianco/white	BM 00601	bianco/white	0,5 (22)	14	8	1	2,6		5000
BM 00502	bianco/white	BM 00702	azzurro/light blue	BM 00602	grigio/grey	0,75 (20)	14	8	1,2	2,8		5000
BM 00503	giallo/yellow	BM 00603	rosso/red	BM 00603	rosso/red	1 (18)	14	8	1,4	3	540	5000
BM 00504	rosso/red	BM 00604	nero/black	BM 00604	nero/black	1,5 (16)	14	8	1,7	3,5		5000
BM 005041	rosso/red	BM 006041	nero/black	BM 006041	nero/black	1,5 (16)	16	10	1,7	3,5		5000
BM 00505	rosso/red	BM 00605	nero/black	BM 00605	nero/black	1,5 (16)	24	18	1,7	3,5		2500
BM 00506	blu/blue	BM 00706	grigio/grey	BM 00506	blu/blue	2,5 (14)	14	8	2,2	4,2	538	2500
BM 005061	blu/blue	BM 007061	grigio/grey	BM 005061	blu/blue	2,5 (14)	18	12	2,2	4,2		2500
BM 00507	blu/blue	BM 00707	grigio/grey	BM 00507	blu/blue	2,5 (14)	24	18	2,2	4,2		2000
BM 00508	grigio/grey	BM 00708	arancio/orange	BM 00508	grigio/grey	4 (12)	17	10	2,8	4,8	541 1661	2000
BM 005081	grigio/grey	BM 007081	arancio/orange	BM 005081	grigio/grey	4 (12)	20	12	2,8	4,8		2000
BM 00509	grigio/grey	BM 00709	arancio/orange	BM 00509	grigio/grey	4 (12)	26	18	2,8	4,8		1000
BM 00510	nero/black	BM 00710	verde/green	BM 00610	giallo/yellow	6 (10)	20	12	3,5	6,3		1000
BM 00511	nero/black	BM 00711	verde/green	BM 00611	giallo/yellow	6 (10)	26	18	3,5	6,3		1000
BM 00512	avorio/ivory	BM 00712	marrone/brown	BM 00612	rosso/red	10 (8)	22	12	4,5	7,6	539 5391	500
BM 00513	avorio/ivory	BM 00713	marrone/brown	BM 00613	rosso/red	10 (8)	28	18	4,5	7,6		500
BM 00514	verde/green	BM 00714	avorio/ivory	BM 00614	blu/blue	16 (6)	24	12	5,8	8,8		500
BM 00515	verde/green	BM 00715	avorio/ivory	BM 00615	blu/blue	16 (6)	28	18	5,8	8,8		500
BM 00516	marrone/brown	BM 00716	nero/black	BM 00616	giallo/yellow	25 (4)	30	16	7,3	11,2		100
BM 00517	beige/beige	BM 00617	rosso/red	BM 00617	rosso/red	35 (2)	30	16	8,3	12,7	527	100
BM 00518	oliva/olive	BM 00618	blu/blue	BM 00618	blu/blue	50 (1)	36	20	10,3	15		50
BM 00519	giallo/yellow					70 (2/0)	37	21	13,5	16		50
BM 00520	rosso/red					95 (3/0)	44	25	14,7	18		50
BM 00521	blu/blue					120 (4/0)	48	27	16,7	20		50
BM 00522	giallo/yellow					150 (300)	58	32	19,5	23		25

TWIN CABLE

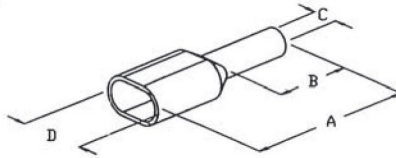

Standard color 1		Standard color 2		Color DIN 46228/4		Section mm² (AWG)	A	B	C int.	D	Tool	Packing pcs.
Type	Color	Type	Color	Type	Color							
BM 00551	arancio/orange	BM 00651	bianco/white	BM 00651	bianco/white	2x0,5 (22)	15	8	1,4	4,7		2000
BM 00552	bianco/white	BM 00753	blu/blue	BM 00652	grigio/grey	2x0,75 (20)	15	8	1,7	5		2000
BM 00553	bianco/white			BM 00653	grigio/grey	2x0,75 (20)	17	10	1,7	5		2000
BM 00554	giallo/yellow	BM 00654	rosso/red	BM 00654	rosso/red	2x1 (18)	15	8	1,95	5,4		2000
BM 00555	giallo/yellow	BM 00655	rosso/red	BM 00655	rosso/red	2x1 (18)	17	10	1,95	5,4	541	2000
BM 00556	rosso/red	BM 00656	nero/black	BM 00656	nero/black	2x1,5 (16)	16	8	2,2	6,6	5382	2000
BM 00557	rosso/red	BM 00657	nero/black	BM 00657	nero/black	2x1,5 (16)	20	12	2,2	6,6	1661	2000
BM 00558	blu/blue	BM 00758	grigio/grey	BM 00558	blu/blue	2x2,5 (14)	18,5	10	2,8	7,8		1000
BM 00559	blu/blue			BM 00559	blu/blue	2x2,5 (14)	21,5	13	2,8	7,8		1000
BM 00560	grigio/grey	BM 00760	arancio/orange	BM 00560	grigio/grey	2x4 (12)	23	12	3,7	8,8		1000
BM 00561	nero/black	BM 00761	verde/green	BM 00661	giallo/yellow	2x6 (10)	26	14	4,8	10	539	500
BM 00562	avorio/ivory	BM 00762	marrone/brown	BM 00662	rosso/red	2x10 (8)	26	14	6,4	13	5391	100
BM 00563	verde/green	BM 00763	avorio/ivory	BM 00663	blu/blue	2x16 (6)	30	14	8,2	18,4	533	50

NYLON INSULATED BLACK COLOR - T 105° C

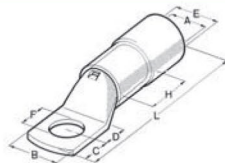

Type	Section mm ² Rigido Flex.	For screw Ø mm	F	A	B	L	H	C	D	E Ø int.	Tool	Packing pcs.
BM 004191	10	5	5,2	5	10	37	9,5	5	6,3	8,2	582 182 183 283 383	100
BM 004311		6	6,3	5	11	40	9,5	5,5	6,5	8,2		100
BM 004371		8	8,5	5	13,6	40,4	9,5	6,2	8,8	8,2		100
BM 004431		10	10,5	5	17,2	48,7	9,5	9,5	9,6	8,2		100
BM 005251	16	5	5,3	6	11,5	43,6	11	6,3	8,7	9	582 182 183 283 383	100
BM 005311		6	6,5	6	11,5	44,6	11	6	8,5	9		100
BM 005371		8	8,5	6	15	44	12	8	9	9		100
BM 005431		10	10,5	6	17,5	49,5	12	10	10,5	9		100
BM 005491	25	12	13	6	17,5	53,5	12	10	10,5	9	582 182 183 283 383	100
BM 006251		5	5,2	7	14	50	13,5	7	10	11,5		100
BM 006311		6	6,3	7	14	50	13,5	7	10	11,5		100
BM 006371		8	8,4	7	14	50	13,5	8	10	11,5		100
BM 006431	35 - 25	10	10,5	7	17	51	14	9,5	10,5	11,5	582 182 183 283 383	100
BM 006491		12	13	7	18,5	51	14	9,5	11	11,5		100
BM 007311		6	6,4	8,5	17	57	15	6	9,5	14		100
BM 007371		8	8,5	8,5	17	56	15	10	10,5	14		100
BM 007431	50	10	10,5	8,5	17	64	15	9,5	12	14	582 182 183 283 383	100
BM 007491		12	13	8,5	17	63	15	11,5	14	14		100
BM 008311		6	6,4	10	18,7	52	18	9	9	15,5		100
BM 008371		8	8,4	10	18,7	61	18	10	10	15,5		100
BM 008431	50 - 35	10	10,5	10	18,7	61	18	11	11	15,5	582 182 183 283 383	100
BM 008491		12	12,5	10	21	69	18	12	15,3	15,5		100
BM 008551		14	14,5	10	22	70	17	12	15,3	15,5		100
BM 009371		8	8,5	12	21,8	72	20,5	10	11	18		100
BM 009431	70 - 50	10	10,5	12	21,8	75	20,5	11,2	14,5	18	184 284 384 186 286	100
BM 009491		12	12,5	12	22	75	20,5	13	13	18		100
BM 009551		14	14,5	12	22	75	20,5	11,3	14	18		100
BM 009611		16	16,5	12	22	75	20,5	11,3	14	18		100
BM 051371	95 - 70	8	8,5	13,8	25	83	23	12,5	12,5	19,5	184 284 384 186 286	50
BM 051431		10	10,5	13,8	25	83	23	12,5	12,5	19,5		50
BM 051491		12	12,5	13,8	25	84	23	13	14	19,5		50
BM 051551		14	14,5	13,8	25	90	23	13	17	19,5		50
BM 051611	120 - 95	16	16,5	13,8	25	89	23	13,5	17	19,5	184 284 384 186 286	50
BM 052371		8	8,5	15,5	28	94	25	14	14	21		50
BM 052431		10	10,5	15,5	28	94	25	14	14	21		50
BM 052491		12	12,5	15,5	28	90	25	14	14	21		50
BM 052551	150 - 120	14	14,5	15,5	28	96	25	16	15	21	184 284 384 186 286	50
BM 052611		16	16,5	15,5	28	102	25	16	15	21		50
BM 053371		8	8,4	17	31	87,5	28	11	13	23		25
BM 053431		10	10,4	17	31	87,5	28	11	13	23		25
BM 053491	185 - 150	12	12,5	17	31	93,5	28	13	14	23	184 284 384 186 286	25
BM 053551		14	14,5	17	31	94	28	15	15,5	23		25
BM 053611		16	16,5	17	31	98	30	16	15	23		25
BM 053671		20	21	17	31	98	30	16	22	23		25
BM 054491	240 - 185	12	13	19	35	90	30	14	16	26	184 284 384 186 286	25
BM 054551		14	15	19	35	98	30	16	18	26		25
BM 054611		16	17	19	35	102	30	17	19	26		25
BM 054671		20	21	19	35	112	30	20	22	26		25
BM 055491	240 - 185	12	13	21,5	39,5	100	35	14	16	30	184 284 384 186 286	25
BM 055551		14	15	21,5	39,5	108	35	16	18	30		25
BM 055611		16	17	21,5	39,5	112	35	17	19	30		25
BM 055671		20	21	21,5	39,5	124	35	20	22	30		25

NYLON INSULATED

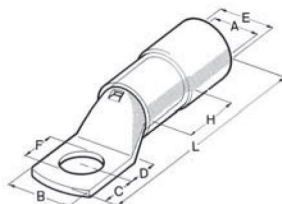

Type	Section mm ² Rigido Flex.	For screw Ø mm	F	A	B	L	H	C	D	E Ø int.	Tool	Packing pcs.
BM 001071	1,5	3	3,2	1,8	8	23	5	4	5	4,2	536	100
BM 001191		4	4,2	1,8	8	23	5	4	5	4,2		100
BM 001251		5	5,2	1,8	8	23	5	4	5	4,2		100
BM 001311		6	6,3	1,8	10	23	5	5	6	4,2		100
BM 002071	2,5	3	3,2	2,4	8	24,3	7	4	5	4,8	534 5341 1661	100
BM 002191		4	4,2	2,4	8	24,3	7	4	5	4,8		100
BM 002251		5	5,2	2,4	10	28,3	7	5	6	4,8		100
BM 002311		6	6,3	2,4	10	24,3	7	5	6	4,8		100
BM 002371	6	8	8,2	2,4	11	29,3	7	6,5	8,5	4,8	536	100
BM 003191		4	4,2	3,8	10	33,3	9	5	6	6,6		100
BM 003251		5	5,2	3,8	10	29,3	9	5	6	6,6		100
BM 003311		6	6,3	3,8	10	29,3	9	5	6	6,6		100
BM 003371	10	8	8,2	3,8	12	35,3	9	6	9	6,6	536	100
BM 003431		10	10,2	3,8	15	42,3	9	9	11	6,6		100
BM 00419		5	5,2	5	10	37	9,5	5	6,3	8,2		100
BM 00420		5	5,2	5	10	37	9,5	5	6,3	14,8		100
BM 00431	16	6	6,3	5	11	40	9,5	5,5	6,5	8,2	582 182	100
BM 00432		6	6,3	5	11	40	9,5	5,5	6,5	14,8		100
BM 00437		8	8,5	5	13,6	40,4	9,5	6,2	8,8	8,2		100
BM 00438		8	8,5	5	13,6	40,4	9,5	6,2	8,8	14,8		100
BM 00443	25	10	10,5	5	17,2	48,7	9,5	9,5	9,6	8,2	183 283 383	100
BM 00444		10	10,5	5	17,2	48,7	9,5	9,5	9,6	14,8		100
BM 00525		5	5,3	6	11,5	43,6	11	6,3	8,7	9		50
BM 00526		5	5,3	6	11,5	43,6	11	6,3	8,7	16,5		50
BM 00531	32	6	6,5	6	11,5	44,6	11	6	8,5	9	184 284 384 260	50
BM 00532		6	6,5	6	11,5	44,6	11	6	8,5	16,5		50
BM 00537		8	8,5	6	15	44	12	8	9	9		50
BM 00538		8	8,5	6	15	44	12	8	9	16,5		50
BM 00543	40	10	10,5	6	17,5	49,5	12	10	10,5	9	186 286	50
BM 00544		10	10,5	6	17,5	49,5	12	10	10,5	16,5		25
BM 00547		12	13	6	17,5	53,5	12	10	10,5	16,5		25
BM 00549		12	13	6	17,5	53,5	12	10	10,5	9		25
BM 00625	50	5	5,2	7	14	50	13,5	7	10	11,5	582 182	25
BM 00626		5	5,2	7	14	50	13,5	7	10	16,8		25
BM 00631		6	6,3	7	14	50	13,5	7	10	11,5		25
BM 00632		6	6,3	7	14	50	13,5	7	10	16,8		25
BM 00637	63	8	8,4	7	14	50	13,5	8	10	11,5	582 182	25
BM 00638		8	8,4	7	14	50	13,5	8	10	16,8		25
BM 00643		10	10,5	7	17	51	14	9,5	10,5	11,5		25
BM 00644		10	10,5	7	17	51	14	9,5	10,5	16,8		25
BM 00649	70	12	13	7	18,5	51	14	9,5	11	11,5	582 182	25
BM 006492		12	13	7	18,5	51	14	9,5	11	16,8		25

NYLON INSULATED

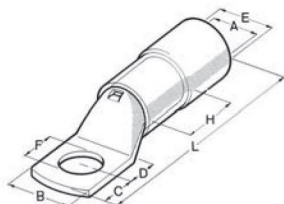

Type	Section mm ² Rigido Flex.	For screw Ø mm	F	A	B	L	H	C	D	E Ø int.	Tool	Packing pcs.
BM 00731	35 - 25 50	6	6,4	8,5	17	57	15	6	9,5	14	582 182 183 283 383	100
BM 00732		6	6,4	8,5	17	57	15	6	9,5	18,7		100
BM 00737		8	8,5	8,5	17	56	15	10	10,5	14		100
BM 00738		8	8,5	8,5	17	56	15	10	10,5	18,7		100
BM 00743		10	10,5	8,5	17	64	15	9,5	12	14		100
BM 00744		10	10,5	8,5	17	64	15	9,5	12	18,7		100
BM 00749		12	13	8,5	17	63	15	11,5	14	14		100
BM 00752		12	13	8,5	17	63	15	11,5	14	18,7		100
BM 00831	50 - 35 50	6	6,4	10	18,7	52	18	9	9	15,5	184 284 384 186 286	100
BM 00832		6	6,4	10	18,7	52	18	9	9	20,8		100
BM 00837		8	8,4	10	18,7	61	18	10	10	15,5		100
BM 00838		8	8,4	10	18,7	61	18	10	10	20,8		100
BM 00843		10	10,5	10	18,7	61	18	11	11	15,5		100
BM 00844		10	10,5	10	18,7	61	18	11	11	20,8		100
BM 00849		12	12,5	10	21	69	18	12	15,3	15,5		100
BM 00852		12	12,5	10	21	69	18	12	15,3	20,8		100
BM 00855	70 - 50 70	14	14,5	10	22	70	17	12	15,3	15,5	260	100
BM 00856		14	14,5	10	22	70	17	12	15,3	20,8		100
BM 00937		8	8,5	12	21,8	72	20,5	10	11	22		50
BM 00943		10	10,5	12	21,8	75	20,5	11,2	14,5	22		50
BM 00949		12	12,5	12	22	75	20,5	13	13	22		50
BM 00955		14	14,5	12	22	75	20,5	11,3	14	22		50
BM 00961		16	16,5	12	22	75	20,5	11,3	14	22		50
BM 05137	95 - 70 95	8	8,5	13,8	25	83	23	12,5	12,5	26	260	25
BM 05143		10	10,5	13,8	25	83	23	12,5	12,5	26		25
BM 05149		12	12,5	13,8	25	84	23	13	14	26		25
BM 05155		14	14,5	13,8	25	90	23	13	17	26		25
BM 05161		16	16,5	13,8	25	89	23	13,5	17	26		25
BM 05237	120 - 95 120	8	8,5	15,5	28	94	25	14	14	27	260	25
BM 05243		10	10,5	15,5	28	94	25	14	14	27		25
BM 05249		12	12,5	15,5	28	90	25	14	14	27		25
BM 05255		14	14,5	15,5	28	96	25	16	15	27		25
BM 05261		16	16,5	15,5	28	102	25	16	15	27		25
BM 05337	150 - 120 150	8	8,4	17	31	87,5	28	11	13	29	260	25
BM 05343		10	10,4	17	31	87,5	28	11	13	29		25
BM 05349		12	12,5	17	31	93,5	28	13	14	29		25
BM 05355		14	14,5	17	31	94	28	15	15,5	29		25
BM 05361		16	16,5	17	31	98	30	16	15	29		25
BM 05367	185 - 150 185	20	21	17	31	98	30	16	22	29	260	25
BM 05449		12	13	19	35	90	30	14	16	32		25
BM 05455		14	15	19	35	98	30	16	18	32		25
BM 05461		16	17	19	35	102	30	17	19	32		25
BM 05467		20	21	19	35	112	30	20	22	32		25
BM 05549	240 - 185 240	12	13	21,5	39,5	100	35	14	16	36	260	25
BM 05555		14	15	21,5	39,5	108	35	16	18	36		25
BM 05561		16	17	21,5	39,5	112	35	17	19	36		25
BM 05567		20	21	21,5	39,5	124	35	20	22	36		25
BM 05649	300 - 240	12	13	24	44	119	38	20	22	33	260	25
BM 05661		16	17	24	44	119	38	20	22	33		25
BM 05667		20	21	24	44	119	38	20	22	33		25

UNINSULATED

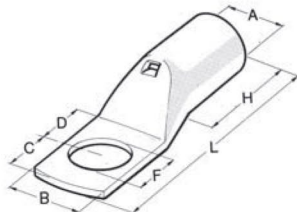

Type	Section mm ² Rigido Flex.	For screw Ø mm	F	A	B	L	H	C	D	Tool	Indent	Packing pcs.
BM 011071	1,5	3	3,2	1,8	8	16	5	4	5	524 535 1661	-	100
BM 011191		4	4,2	1,8	8	16	5	4	5		-	100
BM 011251		5	5,2	1,8	8	16	5	4	5		-	100
BM 011311		6	6,3	1,8	10	18	5	5	6		-	100
BM 012071	2,5	3	3,2	2,4	8	18	7	4	5	525	-	100
BM 012191		4	4,2	2,4	8	18	7	4	5		-	100
BM 012251		5	5,2	2,4	10	20	7	5	6		-	100
BM 012311		6	6,3	2,4	10	20	7	5	6		-	100
BM 012371	4	8	8,2	2,4	11	24	7	6,5	8,5	526	-	100
BM 013190		4	4,2	3,1	10	20	7	5	6		-	100
BM 013250		5	5,2	3,1	10	20	7	5	6		-	100
BM 013310		6	6,3	3,1	10	20	7	5	6		-	100
BM 013370	6	8	8,2	3,1	11	24	7	6,5	8,5	510	-	100
BM 013191		4	4,2	3,8	10	23	9	5	6		-	100
BM 013251		5	5,2	3,8	10	23	9	5	6		-	100
BM 013311		6	6,3	3,8	10	23	9	5	6		-	100
BM 013371	10	8	8,2	3,8	12	27	9	6	9	512 582 523 182 183 383 283	-	100
BM 013431		10	10,2	3,8	15	32	9	9	11		-	100
BM 01419		5	5,2	5	10	26,5	9,5	5	6,3		7	100
BM 01431		6	6,3	5	11	28	9	5,5	8		7	100
BM 01437	16	8	8,5	5	13,6	31,5	9,5	6,2	8,8	510	7	100
BM 01443		10	10,5	5	17,2	34	9,5	9,5	9,6		7	100
BM 01449		12	12,2	5	17	34,1	9,5	9,3	9,3		7	100
BM 01525		5	5,3	6	11,5	30,5	11	6,3	8,7		7,5	100
BM 01531	25	6	6,5	6	11,5	31	11	6	8,5	512 582 523 182 183 383 283	7,5	100
BM 01537		8	8,5	6	15	36	12	8	9		7,5	100
BM 01543		10	10,5	6	17,5	38,5	12	10	10,5		7,5	100
BM 01549		12	13	6	17,5	39	12	10	10,5		7,5	100
BM 01625	35	5	5,2	7	14	37,5	13,5	7	10	512 582 523 182 183 383 283	9	100
BM 01631		6	6,3	7	14	37,5	13,5	7	10		9	100
BM 01637		8	8,4	7	14	37,5	13,5	8	10		9	100
BM 01643		10	10,5	7	17	39,5	14	9,5	10,5		9	100
BM 01649	50	12	13	7	18,5	39,5	14	9,5	11	512 582 523 182 183 383 283	9	100
BM 01731		6	6,4	8,5	17	37	15	6	9,5		11	100
BM 01737		8	8,5	8,5	17	41,5	15	10	10,5		11	100
BM 01743		10	10,5	8,5	17	45	15	9,5	12		11	100
BM 01749	70	12	13	8,5	20	46	15	11,5	14	512 582 523 182 183 383 283	11	100
BM 01831		6	6,4	10	18,7	45,5	18	9	9		12	100
BM 01837		8	8,4	10	18,7	47,5	18	10	10		12	100
BM 01843		10	10,5	10	18,7	49,5	18	11	11		12	100
BM 01849	50	12	12,5	10	21	53	18	12	15,3	512 582 523 182 183 383 283	12	100
BM 01855		14	14,5	10	22	53	17	12	15,3		12	100
BM 01931		6	6,5	12	21,8	51	20,5	10	11		14	100
BM 01937		8	8,5	12	21,8	51	20,5	10	11		14	100
BM 01943	70	10	10,5	12	21,8	57	20,5	11,2	14,5	512 582 523 182 183 383 283	14	100
BM 01949		12	12,5	12	22	57	20,5	13	13		14	100
BM 01955		14	14,5	12	22	57	20,5	11,3	14		14	100
BM 01961		16	16,5	12	22	57	20,5	11,3	14		14	100

UNINSULATED

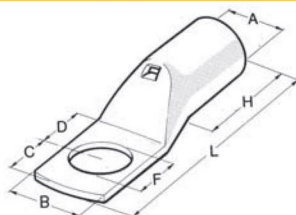

Type	Section mm ² Rigido Flex.	For screw Ø mm	F	A	B	L	H	C	D	Tool	Indent	Packing pcs.
BM 03137	95 - 70 95	8	8,5	13,8	25	60	23	12,5	12,5	512 523	16	50
BM 03143		10	10,5	13,8	25	60	23	12,5	12,5		16	50
BM 03149		12	12,5	13,8	25	62	23	13	14		16	50
BM 03155		14	14,5	13,8	25	65	23	13	17		16	50
BM 03161		16	16,5	13,8	25	65	23	13,5	17		16	50
BM 03237	120 - 95 120	8	8,5	15,5	28	64	25	14	14	582	18	50
BM 03243		10	10,5	15,5	28	64	25	14	14		18	50
BM 03249		12	12,5	15,5	28	64	25	14	14		18	50
BM 03255		14	14,5	15,5	28	67	25	16	15		18	50
BM 03261		16	16,5	15,5	28	70	25	16	15		18	50
BM 03337	150 - 120 150	8	8,4	17	31	64	28	11	13	182 183 283 383	20	50
BM 03343		10	10,4	17	31	64	28	11	13		20	50
BM 03349		12	12,5	17	31	70	28	13	14		20	50
BM 03355		14	14,5	17	31	70,5	28	15	15,5		20	50
BM 03361		16	16,5	17	31	73	30	16	15		20	50
BM 03367	185 - 150 185	20	21	17	31	73	30	16	22	184 284 384 186 286	20	50
BM 03443		10	10,5	19	35	75	30	14	16		22	50
BM 03449		12	13	19	35	75	30	14	16		22	50
BM 03455		14	15	19	35	79	30	16	18		22	50
BM 03461		16	17	19	35	81	30	17	19		22	50
BM 03467	240 - 185 240	20	21	19	35	87	30	20	22	260 270	22	50
BM 03543		10	10,5	21,5	39,5	81	35	14	16		25	50
BM 03549		12	13	21,5	39,5	81	35	14	16		25	50
BM 03555		14	15	21,5	39,5	85	35	16	18		25	50
BM 03561		16	17	21,5	39,5	87	35	17	19		25	50
BM 03567	300 - 240 300	20	21	21,5	39,5	93	35	20	22		25	50
BM 03649		12	13	24	44	101	38	20	22		28	25
BM 03655		14	15	24	44	101	38	20	22		28	25
BM 03661		16	17	24	44	101	38	20	22		28	25
BM 03667		20	21	24	44	101	38	20	22		28	25
BM 03669	400 - 300 400	24	25	24	44	101	38	20	22		28	25
BM 03749		12	13	27	50	108	40	20	22		35	10
BM 03755		14	15	27	50	108	40	20	22		35	10
BM 03761		16	17	27	50	108	40	20	22		35	10
BM 03767		20	21	27	50	108	40	20	22		35	10
BM 03769	500 - 400 500	24	25	27	50	108	40	20	22		35	25
BM 03861		16	17	30	55	124	51	23	25		38	5
BM 03867		20	21	30	55	124	51	23	25		38	5
BM 03961		16	17	33,6	61	131	58	23	25		42	5
BM 03967		20	21	33,6	61	131	58	23	25		42	5

For tube terminals 10-630 mm² available under request version without inspection hole.
To order please you add number "one" to each article number.

UNINSULATED DIN 46235

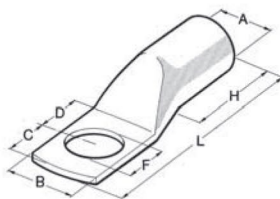

Type	Section mm ²	For screw Ø mm	F	A	B	L	H	C	D	Tool	Indent	Packing pcs.
BM 80425	10	5	5,3	4,5	9	36	10	9	6	525	6	100
BM 80431		6	6,4	4,5	9	36	10	10,5	8		6	100
BM 80531		6	6,4	5,5	13	49	20	10,5	8		8	100
BM 80537	16	8	8,4	5,5	13	49	20	13	10	511	8	100
BM 80543		10	10,5	5,5	17	53	20	15	12		8	100
BM 80631		6	6,4	7	14	48,5	20	10,5	8		10	100
BM 80637	25	8	8,4	7	16	51	20	13	10	513	10	100
BM 80643		10	10,5	7	17	53	20	15	12		10	100
BM 80649		12	13	7	19	54	20	16	13		10	100
BM 80737	35	8	8,4	8,5	17	55	20	13	10	582	12	100
BM 80743		10	10,5	8,5	19	57	20	15	12		12	100
BM 80749		12	13	8,5	21	58	20	16	13		12	100
BM 80837	50	8	8,4	10	20	65	28	13	10	182	14	50
BM 80843		10	10,5	10	22	67	28	15	12		14	50
BM 80849		12	13	10	24	68	28	16	13		14	50
BM 80861	70	16	17	10	28	71	28	19	16	183	14	50
BM 80937		8	8,4	12	24	68	28	13	10		16	50
BM 80943		10	10,5	12	24	70	28	15	12		16	50
BM 80949	95	12	13	12	24	71	28	16	13	186	16	50
BM 80961		16	17	12	30	74	28	19	16		16	50
BM 83143		10	10,5	13,8	28	80	35	15	12		16	50
BM 83149	120	12	13	13,8	28	81	35	16	13	283	18	25
BM 83161		16	17	13,8	32	84	35	19	16		18	25
BM 83243		10	10,5	15,5	32	85	35	15	12		18	25
BM 83249	150	12	13	15,5	32	86	35	16	13	383	20	25
BM 83261		16	17	15,5	32	89	35	19	16		20	25
BM 83267		20	21	15,5	38	92	35	22	20		20	25
BM 83343	185	10	10,5	17	34	93	35	15	12	270	22	25
BM 83349		12	13	17	34	94	35	16	13		22	25
BM 83361		16	17	17	34	97	35	19	16		22	25
BM 83367	240	20	21	17	40	100	35	22	20		22	25
BM 83443		10	10,5	19	37	97	40	15	12		25	10
BM 83449		12	13	19	37	98	40	16	13		25	10
BM 83461		16	17	19	37	101	40	19	16		25	10
BM 83467		20	21	19	40	104	40	22	20		25	10
BM 83549		12	13	21,5	42	107	40	16	13		28	10
BM 83561		16	17	21,5	42	108	40	19	16		28	10
BM 83567		20	21	21,5	45	111	40	22	20		28	10

Copper DIN terminals are available under request, without tin treatment.
To order please you add number "1" to each article number.

UNISULATED silver brasing DIN 46234

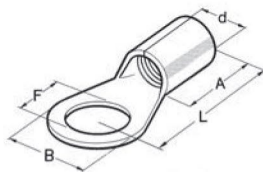

Type	Section mm ²	For screw Ø mm	d	F	B	L	A	Tool	Indent	Packing pcs.
BM 02431	10	6	4,5	6,4	11	17	8	525	6	100
BM 02437		8	4,5	8,4	14	20	8		6	100
BM 02443		10	4,5	10,5	18	21	8		6	100
BM 02449		12	4,5	13	22	23	8		6	100
BM 02531	16	6	5,8	6,4	11	20	10	526	8	200
BM 02537		8	5,8	8,4	14	22	10		8	200
BM 02543		10	5,8	10,5	18	24	10		8	100
BM 02549		12	5,8	13	22	26	10		8	100
BM 02561	25	16	5,8	17	32	36	10	526	8	100
BM 02631		6	7,5	6,4	12	25	11		10	100
BM 02637		8	7,5	8,4	16	25	11		10	100
BM 02643		10	7,5	10,5	18	26	11		10	100
BM 02649	35	12	7,5	13	22	31	11	526	10	200
BM 02655		14	7,5	15	30	37	11		10	200
BM 02661		16	7,5	17	28	35	11		10	100
BM 02737		8	9	8,4	16	26	12		12	100
BM 02743	50	10	9	10,5	18	27	12	526	12	100
BM 02749		12	9	13	22	31	12		12	100
BM 02755		14	9	15	28	36	12		12	100
BM 02761		16	9	17	28	36	12		12	100
BM 02837	70	8	11	8,4	18	34	16	526	14	100
BM 02843		10	11	10,5	18	34	16		14	100
BM 02849		12	11	13	22	36	16		14	100
BM 02855		14	11	15	28	40	16		14	100
BM 02861	95	16	11	17	28	40	16	526	14	100
BM 02937		8	13	8,4	22	38	18		16	50
BM 02943		10	13	10,5	22	38	18		16	50
BM 02949		12	13	13	22	38	18		16	100
BM 02955	120	14	13	15	28	42	18	526	16	100
BM 04137		8	15	8,4	24	42	20		18	100
BM 04143		10	15	10,5	24	42	20		18	50
BM 04149		12	15	13	24	42	20		18	50
BM 04155	150	14	15	15	28	44	20	526	18	100
BM 04161		16	15	17	28	44	20		18	50
BM 04243		10	16,5	10,5	24	44	22		20	50
BM 04249		12	16,5	13	24	44	22		20	25
BM 04255	180	14	16,5	15	28	48	22	526	20	50
BM 04261		16	16,5	17	28	48	22		20	50
BM 04267		20	16,5	21	32	53	22		20	25
BM 04343		10	19	10,5	30	50	24		22	25
BM 04349	210	12	19	13	30	50	24	526	22	25
BM 04355		14	19	15	30	50	24		22	50
BM 04361		16	19	17	30	50	24		22	25
BM 04367		20	19	21	36	63	24		22	25

STRIP 10 WAYS

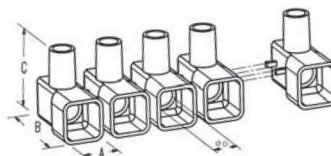

Type	Section mm ²	Connecting capacity			Rated voltage	Ø D	A	B	C	Ways	packing pcs.
		Section mm ²	Rigid conductors Nr.	Flexible conductors Nr.							
BM 991	1,5	1,5	2	2	450 V	IP 20	3,1	7,5	15	10	10-300
		1	2 ÷ 3	2 ÷ 3							
		0,75	2 ÷ 4	2 ÷ 4							
BM 992	2,5	2,5	2	2	450 V	IP 20	4,1	9	17,5	10	10-600
		1,5	2 ÷ 3	2 ÷ 3							
		1	2 ÷ 4	2 ÷ 4							
BM 9924	4	4	2	2	450 V	IP 20	4,5	10,3	21	10	10-400
		2,5	2 ÷ 3	2 ÷ 3							
		1,5	2 ÷ 4	2 ÷ 4							
BM 993	6	6	2	2	450 V	IP 20	6	11,8	22,5	10	10-300
		4	2 ÷ 3	2							
		2,5	2 ÷ 4	2 ÷ 4							
BM 994	10	10	2	2	450 V	IP 00	7,9	14,7	26	10	10-200
		6	2 ÷ 3	2							
		4	2 ÷ 4	2 ÷ 4							
BM 995	16	16	2	2	450 V	IP 00	10,5	18,8	31,8	10	10-100
		10	2 ÷ 3	2							
		6	2 ÷ 4	2 ÷ 3							

SINGLE END-CONNECTOR TERMINAL BLOCK

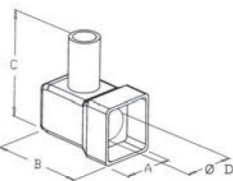

Type	Section mm ²	Connecting capacity			Rated voltage	Ø D	A	B	C	packing pcs.
		Section mm ²	Rigid conductors Nr.	Flexible conductors Nr.						
BM 9960	25	25	2	2	450 V	IP 00	12	22,5	36,3	25
		16	2 ÷ 3	2 ÷ 3						
		10	2 ÷ 4	2 ÷ 4						
BM 9961	35	35	2	2	450 V	IP 00	13,9	26,1	43,5	25
		25	2 ÷ 3	2						
		16	2 ÷ 4	2 ÷ 3						

Housing material: polycarbonate transparent UL 94 - V0

Exercise temperature: T 85°C

Clamps: Brass

Screws: Galvanized steel

High mechanic resistance with high electrical characteristics

According norms: EN 60998-1: 2004

EN 60998-2-1: 2004

TWIN END-CONNECTORS

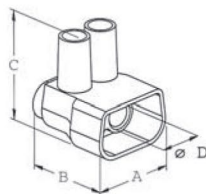

Type	Section Nr x mm ²	Connecting capacity			Rated voltage	Ø D	A	B	C	packing pcs.
		Section mm ²	Rigid conductors Nr.	Flexible conductors Nr.						
BM 9416	2 x 16	16	2	-	450 V	5,5	20,5	22,6	24,5	30
		10	2	2						
		6	2	2						
BM 9425	2 x 25	25	2	-	450 V	7	25	26,2	25,4	20
		16	2	2						
		10	2	2						
BM 9435	2 x 35	35	2	-	450 V	9	32	31,2	33,4	10
		25	2	2						
		16	2	2						

Housing material: polycarbonate trasparent

Self-extinguishing: UL 94-V0; IEC 695-2-1 to 850°C

Exercise temperature: T 85°C

Clamps: Brass

Screws: Galvanized steel

According norms: EN 60998-1: 2004

CEI 23-21 - II Ed. (EN 60998-2-1) + V1

SPLICING WIRE CONNECTORS FOR SOLID WIRE



Type	Conductor section mm ²	Ways	Nominal voltage	Wire strip lenght mm	Packing pcs.
BM 803	0,75 ÷ 2,5	3	450 V	10 ÷ 13	100
BM 805	0,75 ÷ 2,5	5	450 V	10 ÷ 13	100

Material: Polyamide 6.6

Self-Extinguishing: UL 94 - V2; IEC 695-2-1 to 850° C; IEC 695-2-2

Working temperature: T 85° C

According norms: EN 60998-1 (CEI 23-20 + V1)

EN 60998-1 A1

EN 60998-2-2

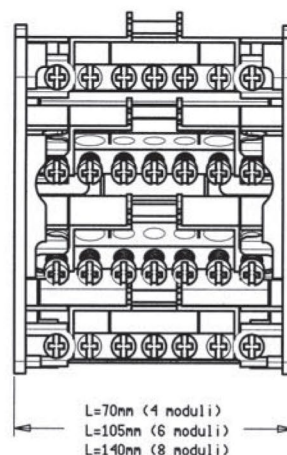
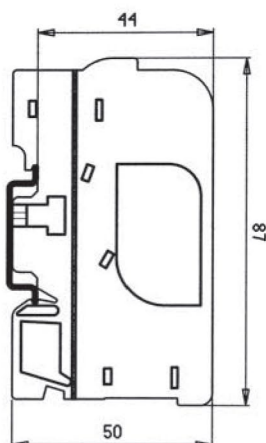
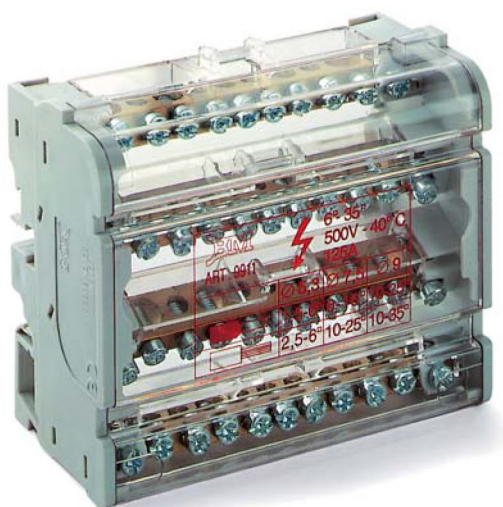

FOUR POLE 100 A

Type	Nr. of the forms-width 17,5 mm	Current peak value	Connection number hole Ø mm	Conductor cross section with end-sleeve mm ²	Conductor cross section mm ²	Packing pcs.
BM 9907	4	lcc 20 kA	5 x Ø 5,3	1,5 - 6	2,5 - 6	1/5
			2 x Ø 7,5	6 - 16	10 - 25	

FOUR POLE 125 A

Type	Nr. of the forms-width 17,5 mm	Current peak value	Connection number hole Ø mm	Conductor cross section with end-sleeve mm ²	Conductor cross section mm ²	Packing pcs.
BM 9911	6	lcc 20 kA	7 x Ø 5,3	1,5 - 6	2,5 - 6	1/5
			2 x Ø 7,5	6 - 16	10 - 25	
			2 x Ø 9	10 - 25	10 - 35	
BM 9915	8	lcc 18 kA	11 x Ø 5,3	1,5 - 6	2,5 - 6	
			2 x Ø 7,5	6 - 16	10 - 25	
			2 x Ø 9	10 - 25	10 - 35	

Housing material: Polycarbonate (PC)

Self-extinguishing: UL-94 V-0 IEC 695-2-1 a 960°C - IEC 695-2-2

Bars of connection: brass

Screws: Galvanized steel, Phillips + slotted head

Rated insulation voltage: 500 V

Test voltage: 3000 V

Tightening torque on the screw: 2,0 Nm

Fixing: On rail conforming to EN 50022 or through the fixing screws

ACCORDING NORMS: CEI EN 60998-1

CEI EN 60998-2-1

EN 60947-1

CABLE-GLANDS

APPROPRIATE PRESSURES

A cable-gland seems to be a component so poor that to not merit the interest of the end-user. But this latter knows that its function, especially in particular installations where the environment is subjected to mechanical or chemical stresses, or even environmental, should not be underestimated. Choosing a quality cable-gland guarantees from incidents and damages that could be dangerous and expensive.

BM offers cable-glands in Nylon or in brass, with universal locking system, with metric thread, PG or GAS, with locknut. And on catalogue, you can find relative accessories, from hex nuts to stop-ends. All this to have the solution adapted to the problem.



USE

Cable-glands are assembled with operative units designed for the specific needs of each item. This will ensure a high level of quality required for each product. Particular care should be taken to apply the minimum value of torque so that to ensure the IP68 protection. Stand-off holes must have prefixed values. Apposite tables link the thread (metric, PG or GAS) with thread diameter and hole diameter.

MATERIALS

Depending on the expected use, BM produces cable-glands with different materials, still always of very high quality.

Nylon. The selection of polymers processed by BM, with high technology equipments, are provided by prestigious multinational companies in order to guarantee a high quality product.

Brass. Also in this case the choice is dictated by the specifications set by international regulations.

Rubber. The elastomers used for gaskets guarantee the IP protection grade and the reported temperature ranges.

MANUFACTURING

Components of cable-glands in Nylon are produced with moulds specifically designed and built by BM, with injection moulding machines with computerized process control.

ASSEMBLY

The high quality level that the product specifications require is made real by assembling of the cable glands with operative units especially designed for the requirements of every single cable gland.

The European Technical committee "CENELEC" has introduced the new European standard EN 50262 regarding the cable-glands for electrical installation whose threading must have a metric thread which conforms to the EN 60423 standard, Tab. 1 and substitutes from 01/03/2001 all the national construction standards relative to cableglands with threading pitch PG-DIN 40430 or GASISO 228/1. We advise therefore, in the realization of new products, to only use cable-glands with a metric thread from M12 to M63. The cableglands with PG or GAS thread shall be, however, still available for the existing appliances. The standards also establish that the cable-glands must have a minimum grade of protection IP 54 in accordance with the standard EN 60529 and must be adapted to use within a minimum range of temperature from -20° C to 65° C with tolerance $\pm 2^\circ$ C. The clearance holes must have the values indicated in Tab. 1.

Tab. 1

Metric Thread	Thread diam.	Hole diameter
EN 60423	mm	mm
M 12x1,5	12,0	12,5
M 16x1,5	16,0	16,5
M 20x1,5	20,0	20,5
M 25x1,5	25,0	25,5
M 32x1,5	32,0	32,5
M 40x1,5	40,0	40,5
M 50x1,5	50,0	50,5
M 63x1,5	63,0	63,5

Tab. 2

PG Thread	Thread diam.	Hole diameter
DIN 40430	mm	mm
PG 7	12,5	13,0
PG 9	15,2	15,5
PG 11	18,6	19,0
PG 13,5	20,4	21,0
PG 16	22,5	23,0
PG 21	28,3	28,5
PG 29	37,0	37,5
PG 36	47,0	47,5
PG 42	54,0	54,5
PG 48	59,3	60,0

Tab. 3

GAS Thread	Thread diam.	Hole diameter
ISO 228/1	mm	mm
GAS 1/4	13,2	13,5
GAS 3/8	16,7	17,0
GAS 1/2	21,0	21,5
GAS 5/8	22,9	23,5
GAS 3/4	26,4	27,0
GAS 1	33,3	33,5
GAS 1 1/8	37,9	38,5
GAS 1 1/4	41,9	42,5
GAS 1 1/2	47,8	48,0
GAS 2	59,6	60,0
GAS 2 1/2	75,2	75,5
GAS 3	87,9	88,5

- Body and pressure-screw made of polyamide 6.6
- Self-extinguishing test according UL94 -V2
- Glow-wire test 850°C according IEC 695-2-1
- Nitril rubber gasket NBR 60° shore, oils and greasy resistant
- Exercise temperature: -20°C +90°C, short period 120°C
- Colors: Grey RAL 7035 and black

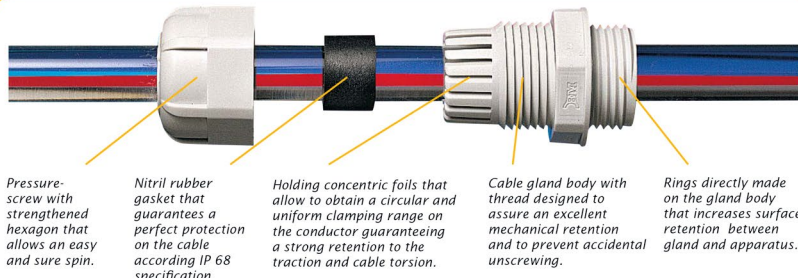

Minimum value of torque to guarantee the IP 68 protection

Metric Thread	Torque Nm	PG Thread	Torque Nm
EN 60423		DIN 40430	
M 12x1,5	2	PG 7	2,5
M 16x1,5	2,5	PG 9	3,75
M 20x1,5	5	PG 11	3,75
M 25x1,5	6	PG 13,5	5
M 32x1,5	7	PG 16	6
M 40x1,5	10	PG 21	7
M 50x1,5	11,5	PG 29	10
M 63x1,5	12,5	PG 36	11,5
		PG 42	12,5
		PG 48	12,5

Comparison of span capacity cable PG-metric thread

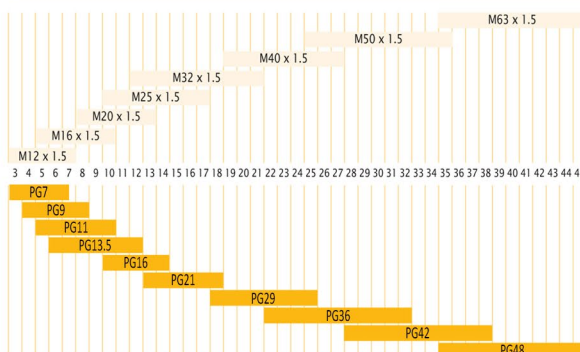

Cable glands in polyamide EN 50262 with stress relief - metric thread - IP 68

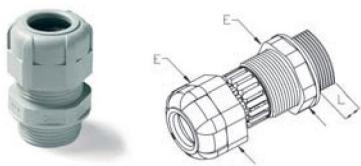

Material: Polyamide 6.6, self-extinguishing according norms: UL 94 - V2 and IEC 695-2-1 to 850°C
Temperature range: -20°C +90°C for short time: +120°C
Gasket: NBR nitrile rubber, 60° Shore
Grade of protection: IP 68
Color: Grey RAL 7035

Type	Thread size EN 60423	Clamping range cable Ø mm	L	E nut	Packing pcs.
BM 4912	M 12 x 1,5	3-7	8	15	50
BM 4917	M 16 x 1,5	5-10	8	19	50
BM 4920	M 20 x 1,5	8-12	9	25	25
BM 4925	M 25 x 1,5	10-17	10	30	25
BM 4932	M 32 x 1,5	12-21	10	36	20
BM 4940	M 40 x 1,5	19-25	10	46	10
BM 4950	M 50 x 1,5	25-35	12	55	5
BM 4963	M 63 x 1,5	35-45	12	66	5

CABLE GLAND WITH HEXAGONAL LOCKNUT



Type	Thread size EN 60423	Clamping range cable Ø mm	L	E nut	E1 locknut	Packing pcs.
BM 4712	M 12 x 1,5	3-7	8	15	17	25
BM 4717	M 16 x 1,5	5-10	8	19	22	25
BM 4720	M 20 x 1,5	8-12	9	25	26	25
BM 4725	M 25 x 1,5	10-17	10	30	32	20
BM 4732	M 32 x 1,5	12-21	10	36	41	20
BM 4740	M 40 x 1,5	19-25	10	46	50	10
BM 4750	M 50 x 1,5	25-35	12	55	60	5
BM 4763	M 63 x 1,5	35-45	12	66	75	5

HEXAGONAL LOCKNUTS IN POLYAMIDE WITH METRIC THREAD



Material: Polyamide glass fibre reinforced
Color: Grey RAL 7035

Type	Thread size EN 60423	E	B	Packing pcs.
BM 4812	M 12 x 1,5	17	5	100
BM 4817	M 16 x 1,5	22	5	100
BM 4820	M 20 x 1,5	26	6	100
BM 4825	M 25 x 1,5	32	6	100
BM 4832	M 32 x 1,5	41	7	50
BM 4840	M 40 x 1,5	50	7	25
BM 4850	M 50 x 1,5	60	8	25
BM 4863	M 63 x 1,5	75	8	10

Cable glands in polyamide with stress relief “PG” thread - IP 68

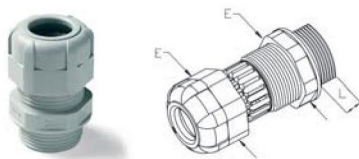

Material: Polyamide 6,6, self-extinguishing
according norms: UL 94 - V2 and IEC 695-2-1
to 850°C

Temperature range: -20°C +90°C for short time: +120°C

Gasket: NBR nitrile rubber, 60° Shore

Grade of protection: IP 68

Light grey RAL 7035 Type	Silver grey RAL 7001 Type	Thread size DIN 40430	Clamping range cable Ø mm	L	E Nut	Packing pcs.
BM 4007	BM 4307	PG7	3 - 7	8	15	50
BM 4009	BM 4309	PG9	5 - 10	8	19	50
BM 4011	BM 4311	PG11	8 - 12	9	25	25
BM 4013	BM 4313	PG13,5	8 - 12	9	25	25
BM 4016	BM 4316	PG16	10 - 17	10	30	25
BM 4021	BM 4321	PG21	12 - 21	10	36	20
BM 4029	BM 4329	PG29	19 - 25	10	46	10
BM 4036	BM 4336	PG36	25 - 35	12	55	5
BM 4942	BM 4342	PG42	28 - 38	13	60	5
BM 4948	BM 4348	PG48	35 - 45	12	66	5

CABLE GLAND WITH HEXAGONAL LOCKNUT

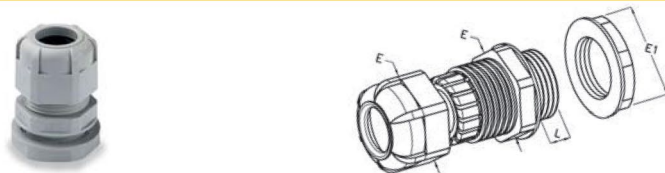

Type	Thread size DIN 40430	Clamping range cable Ø mm	L	E nut	E1 locknut	Packing pcs.
BM 4707	PG 7	3-7	8	15	19	10/100
BM 4709	PG 9	5-10	8	19	22	10/100
BM 4711	PG 11	8-12	9	25	24	10/100
BM 4713	PG 13,5	8-12	9	25	27	10/100
BM 4716	PG 16	10-17	10	30	30	10/100
BM 4721	PG 21	12-21	10	36	36	10/100
BM 4729	PG 29	19-25	10	46	46	10/100
BM 4736	PG 36	25-35	12	55	60	5/50
BM 4742	PG 42	28-38	13	60	65	5/50
BM 4748	PG 48	35-45	12	65	70	5/50

HEXAGONAL LOCKNUTS IN POLYAMIDE WITH “PG” THREAD



Type	Thread size DIN 40430	E	B	Packing pcs.
BM 4807	PG 7	19	5	100
BM 4809	PG 9	22	5	100
BM 4811	PG 11	24	5	100
BM 4813	PG 13,5	27	6	100
BM 4816	PG 16	30	6	100
BM 4821	PG 21	36	7	100
BM 4829	PG 29	46	7	50
BM 4836	PG 36	60	8	25
BM 4842	PG 42	65	8	25
BM 4848	PG 48	70	8	10

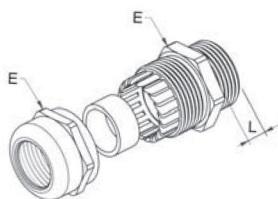

Material: Brass nickel plated
Range of temperature: -40°C +120°C
Gasket: NBR rubber
O-ring: NBR rubber

METRIC THREAD

Type	Thread	Clamping range cable Ø mm	E1 nut	E nut	L	Packing pcs.
BM 2512	M 12 x 1,5	3 - 6,5	14	14	6	100
BM 2517	M 16 x 1,5	4 - 8	18	18	7	100
BM 2520	M 20 x 1,5	6 - 12	22	22	9	100
BM 2525	M 25 x 1,5	10 - 14	24	27	9	100
BM 2532	M 32 x 1,5	15 - 22	34	34	10	40
BM 2540	M 40 x 1,5	18 - 25	45	45	10	20
BM 2550	M 50 x 1,5	25 - 32	50	55	10	12
BM 2563	M 63 x 1,5	37 - 44	64	68	12	7

PG THREAD

Type	Thread	Clamping range cable Ø mm	E1 nut	E nut	L	Packing pcs.
BM 2507	PG 7	3 - 6,5	14	14	6	100
BM 2509	PG 9	4 - 8	18	18	7	100
BM 2511	PG 11	5 - 10	20	20	7	100
BM 2513	PG 13,5	6 - 12	22	22	8	100
BM 2516	PG 16	10 - 14	24	24	8	100
BM 2521	PG 21	13 - 18	30	30	9	50
BM 2529	PG 29	18 - 25	40	40	10	25
BM 2536	PG 36	25 - 32	50	50	10	12
BM 2542	PG 42	32 - 38	58	58	12	10
BM 2548	PG 48	37 - 44	64	64	12	7

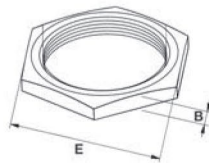

METRIC THREAD

Type	Thread	E	B	Packing pcs.
BM 2712	M 12 x 1,5	15	2,8	100
BM 2716	M 16 x 1,5	19	3	100
BM 2720	M 20 x 1,5	24	3,2	100
BM 2725	M 25 x 1,5	30	3,5	100
BM 2732	M 32 x 1,5	37	4	50
BM 2740	M 40 x 1,5	46	5	25
BM 2750	M 50 x 1,5	60	5,5	25
BM 2763	M 63 x 1,5	70	5,7	10

GAS THREAD

Type	Thread	E	B	Packing pcs.
BM 2460	1/4"	15	2,8	100
BM 2461	3/8"	19	3,2	100
BM 2462	1/2"	24	3,75	100
BM 2463	5/8"	26	3,75	100
BM 2464	3/4"	30	4	100
BM 2465	1"	37	4,5	50
BM 2466	1" 1/8	42	5	50
BM 2467	1" 1/4	46	5	25
BM 2468	1" 1/2	54	5,5	20
BM 2469	2"	65	5,7	20
BM 24692	2" 1/2	80	7	10
BM 24693	3"	95	8	10

PG THREAD

Type	Thread	E	B	Packing pcs.
BM 2696	PG 7	15	2,8	100
BM 2697	PG 9	18	3	100
BM 2698	PG 11	21	3	100
BM 2699	PG 13,5	23	3	100
BM 2700	PG 16	26	3,25	100
BM 2701	PG 21	32	3,5	100
BM 2702	PG 29	42	4	100
BM 2703	PG 36	51	5	50
BM 2704	PG 42	60	5	10
BM 2705	PG 48	65	5,5	10



CRIMPING TOOLS

Crimping a connector to a cable is an operation only in appearance simple. In fact, crimping is an elementary operation the importance of which must not be underrated.

It must not be forgotten that from the quality of crimping operation depends the correct functioning of the whole electrical wiring.

For this reason it is necessary to add to the high quality of the BM's connectors the BM's tooling: BM always assure very important solutions to meet all contractors requirements. This is confirmed by the new tooling line.

BM crimping systems guarantee simplicity of operations together with maximum safety, long duration and high productivity on industrial applications.

The hydraulic units foot, electric or pneumatic alimentation combine the main function to make crimping operations with subsidiary functions as to drill steel sheets or to bend and to drill copper bars with the simple headstock change.

Dies are made in alloyed carbon steel and their stamps are drawn to assure a crimping operation with high retention force of the connector to the cable with values contained in the strictest international standards.

1. CHOICE OF THE CONNECTOR

In order to obtain a connection that can be guaranteed for a long time it is necessary to select the connector suitable to the application field and strictly conformed to the section of the cable to be crimped (See tab. 1). In the large range of BM products you will certainly be able to find the ideal solution for every requirement.

TABLE 1 - CONVERSION AWG/mm²

AWG	mm ²	Ø mm Conductors	AWG	mm ²	Ø mm Conductors	MCM	mm ²	Ø mm Conductors
22	0,324	0,643	9	6,63	2,91	250	126,6	12,70
21	0,412	0,724	8	8,37	3,26	300	152,1	13,92
20	0,519	0,813	7	10,6	3,66	350	177,6	14,04
19	0,653	0,912	6	13,3	4,12	400	202,2	15,04
18	0,823	1,02	5	16,4	4,62	450	237,93	16,05
17	1,04	1,15	4	21,2	5,19	500	252,9	17,95
16	1,31	1,29	3	26,7	5,82	550	278,9	18,85
15	1,65	1,45	2	33,6	6,54	600	304,3	19,69
14	2,08	1,63	1	42,4	7,35	650	328,9	20,47
13	2,63	1,83	1/0	55,5	8,40	750	380	21,99
12	3,31	2,05	2/0	67,4	9,26	800	406	22,73
11	4,17	2,30	3/0	85,01	10,40	1000	508	25,43
10	5,26	2,59	4/0	107,2	11,68	1250	635	28,43

2. STRIPPING

Every crimping operation requires that the cable is first stripped without deforming the wires and for a length as indicated bellow:

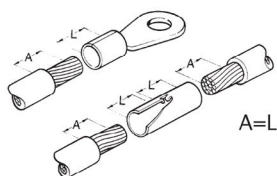

Sezione mm ²	Section mm ²	Tolleranza spelatura ± mm	Stripping tolerance ± mm
0,5	2,5	0,8	
4	6	1,2	
10	120	1,6	
150	630	3,2	

3. ASSEMBLING

- 1) Fit into the connector the cable with a round section for the complete length of the stripped area.
- 2) Verify that there are not wires out the connector. If you need to use sectoral cables you must arrange a previous rounding crimping operation.

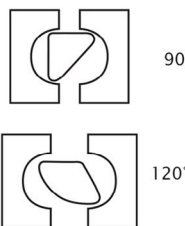

4. CHOICE OF THE CRIMPING TOOL

All dies and punchers of the BM crimping systems guarantee a high degree of retention of the connector to the cable. Make the crimping operation as show in the drawing 1 on the terminals and as drawing 2 on the butt connectors.

The elevated pressure exerted by dies on terminal cause a uniform deformation on the whole crimping area.

Fig.1

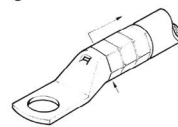
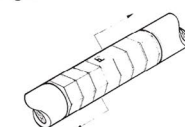

Fig.2













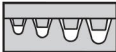

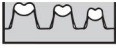

Strong plier made with special tool steel and ergonomic handles made with high adherence plastic material. With the peculiar mechanics of parallel movement and the optimization of the transmission levering with high demultiplication coefficient are guaranteed precise and high reliability crimping operations, with 30% reduced hand force. Safety device with automatic unclamping for operation's uniformity and emergency device so that incorrect terminal setting can be modified in half way crimping. Attachable locators for precise positioning of crimping terminals and for photovoltaic connectors.

Type	Description
BM 6534	Parallel crimping tool with plastic case

DIES FOR BM 6534

Type	Description		
BM 634D	Die for insulated terminals 0,25-6 mm ² (AWG 22-10)		
BM 635D	Die for uninsulated copper terminals 0,5-10 mm ² (AWG 20-8)		
BM 636D	Die for insulated terminals 10-16 mm ² (AWG 8-6)		
BM 631D	Die for barrel open brass terminals 0,1-2,5 mm ² (AWG 27-14) series '110' and '187'		
BM 6534I	Locator for barrel open brass terminal tab mm 2,8-4,8 (series 110-187)		
BM 6311D	Die for barrel open brass terminals 0,5-6 mm ² (AWG 20-10) series '187' and '250'		
BM 65342	Locator for barrel open brass terminal tab mm 4,8-6,3 (series 187-250)		
BM 6321D	Die for barrel open brass terminals 90° 0,5-1 mm ² (AWG 20-18) series '250'		
BM 6322D	Die for barrel open brass terminals 90° 1,25-2,5 mm ² (AWG 17-14) series '250'		

DIES FOR PHOTOVOLTAIC CONNECTORS

Type	Description	mm ²	Capacity	AWG	Geometry
BM 6313D	Die for connectors MC3 with locator	2,5 - 4 - 6		14 - 12 - 10	
BM 6314D	Die for connectors MC4	2,5 - 4 - 6		14 - 12 - 10	
BM 6315D	Locator for connectors MC4				
BM 6316D	Die for connectors Tyco	1,5 - 2,5 - 4 - 6		16 - 14 - 12 - 10	
BM 6317D	Locator for connectors Tyco				

Other dies are available on request.
Stripping plier for solar cables 1,5-2,5-4-6 art. BM 548.

Due to the high quality of their components, to the ruggedness and simple working they are particularly suggested for industrial uses.

Dies are made of microcasted steel and handles of pressed steel with insulation of plastic material bicomponent for soft and ergonomic handling. Possibility to adjust the crimping force through the central hexagonal pin. Equipped with safety device and automatic unclamping to prevent the accidental opening of the dies before the complete execution of the crimping operation, so that uniformity of the connections is always guaranteed.

Type
Description

BM 534

For insulated terminals 0,25-6 mm² (AWG 22-10)

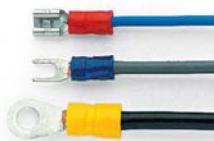

BM 537

For end sleeves terminals 0,5-4 mm² (AWG 22-12)



BM 539

For end sleeves terminals 6-16 mm² (AWG 10-6)



BM 533

For end sleeves terminals 10-35 mm² (AWG 8-2)

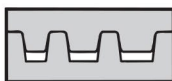

BM 531

For barrel open terminals 0,5-6 mm² (AWG 20-10)

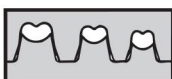

The new BM's professional crimping tool range, thanks to the peculiar ergonomical handles drawings and a new system of levers with an elevated gear ratio, they allow, with a small effort, the uniformity of the connections of insulated and uninsulated terminals in conformity with the crimped cables tensile tests, according to CEI 20-28 and UL 486A norms.

They are strong pliers, manufactured with high quality components, protected with surface treatments that assure a top wear resistance degree.

The main characteristics are:

- 1 Ergonomic handles outline details that permit to make the crimping operation with extreme facility, and also with plier totally open, the possibility only one hand operation.
- 2 Round plastic handles with high adherence degree for easy handling.
- 3 High demultiplication coefficient to achieve the maximum crimping pressure with minimal operative effort.
- 4 Pin release regulation device, for a perfect joining of the dies.
- 5 Safety device and automatic unclamping to prevent the accidental opening of the dies before the complete execution of the crimping operations so that reliability and uniformity of the connections are always guaranteed.
- 6 Emergency device so that incorrect terminal settings can be modified in half way crimping.
- 7 A variety of high precision crimping dies are available: for insulated and uninsulated terminals, for open brass barrel terminals, for end-sleeves terminals from 0.25 to 50 mm².

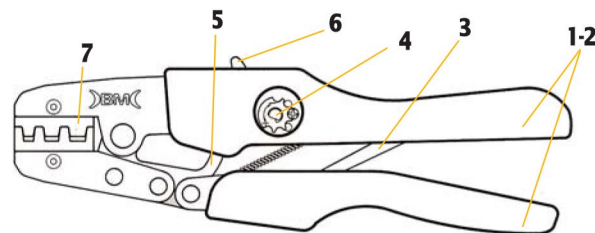





Type
Description

BM 5345

Assortment kit in plastic case complete with tool BM 5341 and 4 dies set

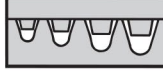

Description	Spare part		
Die for insulated terminal 0,25-6 mm ² (AW 22-10)	BM 534D		
Die for end-sleeves terminals 0,5-4 mm ² (AWG 22-12)	BM 537D		
Die for end sleeves terminals 6-16 mm ² (AWG 10-6)	BM 539D		
Die for barrel open terminals 0,5-6 mm ² (AWG 20-10)	BM 531D		
Die for uninsulated copper terminals 0,5-10 mm ² (AWG 20-8)	BM 535D		

Type
Description

BM 5341

For insulated terminals 0,25-6 mm² (AWG 22-10)

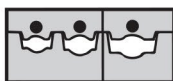

BM 5371

For end sleeves terminals 0,5-4 mm² (AWG 22-12)



BM 5391

For end sleeves terminals 6-16 mm² (AWG 10-6)



BM 5331

For end-sleeves terminals 25-50 mm² (AWG 4-1)

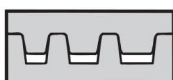

BM 5313

For barrel open terminals 0,5-6 mm² (AWG 20-10)



BM 5314

For 90° female terminal 1 mm² (AWG 18)



BM 5315

For 90° female terminal 2,5 mm² (AWG 14)



BM 5351

For uninsulated copper terminals 0,5-10 mm² (AWG 20-8)

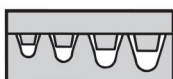

BM 5431

For coaxial connectors RG58-59

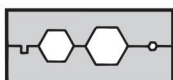









Hand hydraulic press for uninsulated copper terminals, for "C" connectors and for aluminum terminals. Really compact and with light weight (Dim. 120x370 mm, 2 Kg) guaranteed a dies force of 50 kN. 180° adjustable headstock easy dies changeament guaranteed of yoke and latch type head. Equipped with maximum pressure valve so that a perfect crimping execution is always guaranteed.
Hydraulic oil: 50 cc Shell T15

Type	Description
BM 182	Assortment with: Hand hydraulic press 50 kN Dies-set for uninsulated terminals 10 ÷ 150 mm ² Dies-set for C derivator 16 ÷ 35 mm ² Carrying case.
BM 182P	Hand hydraulic press 50 kN with carrying case
BM 1824	Assortment with: Hand hydraulic press 50 kN Dies-set for uninsulated terminals 10 ÷ 240 mm ² Carrying case.

DIES FOR BM 182

Sec. mm²	Uninsulated		Insulated		“C” sleeves		DIN Terminals		High voltage		Aluminum		Prerounding	End-sleeves	
															
	Type	ID	Type		Type		Type	ID	Type		High voltage	For conductors DIN 48201			
Type		Type		Type		Type		Type		Type		Type		Type	
10	BM 182010	7	BM 182110	BM 182210	BM 182310	6									
16	BM 182016	7,5	BM 182116	BM 182225	BM 182316	8									
25	BM 182025	9	BM 182125		BM 182325	10	BM 182325	10				BM 182035	12		
35	BM 182035	11	BM 182135	BM 182235	BM 182335	12	BM 182035	12				BM 182435	13		
50	BM 182035	12	BM 182150		BM 182335	14		20				BM 182450	15	BM 182550	BM 182650
70	BM 182025	14	BM 182170		BM 182325	16		BM 182016	16			BM 182010	18	BM 182570	BM 182670
95	BM 182016	16	BM 182195		BM 182316	18		BM 182015	20			BM 182495	21	BM 182595	BM 182695
120	BM 182010	18			BM 182310	20	BM 182018	22			BM 182018	22	BM 182512	BM 182612	
150	BM 182015	20			BM 182018	22		25				BM 182024	25	BM 182515	BM 182615
185	BM 182018	22			BM 182024	25									
240	BM 182024	25													

AUTOMATIC STRIPPING TOOL



Type	Section mm ²	 g	 n.
BM 1370	0,2 - 6	105	1/6

High resistance plastic material.
No adjustment to conductor cross-section required.
For stranded and solid 0,2-6 mm² conductors (24-10 AWG).
Adjustable length stop of 5 to 12 mm. Easily accessible built-in side cutter for max Ø2 mm.

AUTOMATIC STRIPPING TOOL



Type	Section mm ²	 g	 n.
BM 1371	0,5 - 16	205	1/6

High resistance plastic material.
No adjustment to conductor cross-section required.
ROUND CABLES
For flexible conductors from 0,5 to 16 mm² (20-6 AWG) and for solid conductors from 0,5 to 10 mm² (20-8 AWG).
FLAT CABLES
For cables and wires with PVC insulation from 0,75 to 1,5 mm².

"เหนือกว่ารางวัลใดๆ คือ**ความไว้วางใจ**ของลูกค้า"

- » Automation
- » Process Control
- » Electrical Installation & Control
- » Power Distribution

ไม่เพียงแต่จำหน่ายสินค้าเท่านั้น
เรายังมีวิศวกรผู้เชี่ยวชาญเฉพาะทาง
พร้อมบริการและให้คำปรึกษาแก่ท่าน



CONSULTATION SERVICE



ทีมประสานงานขาย
พร้อมให้ข้อมูล
และความสะดวกสบายแก่ท่าน

CALL CENTER

เราเตรียมสินค้าไว้ในคลัง
พร้อมจัดส่งให้ท่าน
อย่างรวดเร็ว



LARGE INVENTORIES FOR FAST DELIVERY



เรารับรองสินค้าของเราว่า
เป็นสินค้าที่มีคุณภาพและได้รับ
การรับรองคุณภาพจากผู้ผลิต

PRODUCT WARRANTY

เราจัดสัมมนาตลอดทั้งปี
เพื่อให้คำแนะนำ
และแลกเปลี่ยนความรู้กับท่าน



SEMINAR



ฝ่ายซ่อมบำรุง มีความชำนาญและ
เครื่องมือที่ครบครัน จึงสามารถเชื่อถือได้ว่า
สินค้าของท่านอยู่ในความดูแลของเราเสมอ

REPAIR AND MAINTENANCE SERVICE

เรามีการจัดอบรมที่หลากหลาย
เพื่อเพิ่มพูนศักยภาพของพนักงาน
ทุกส่วน



IN-HOUSE TRAINING

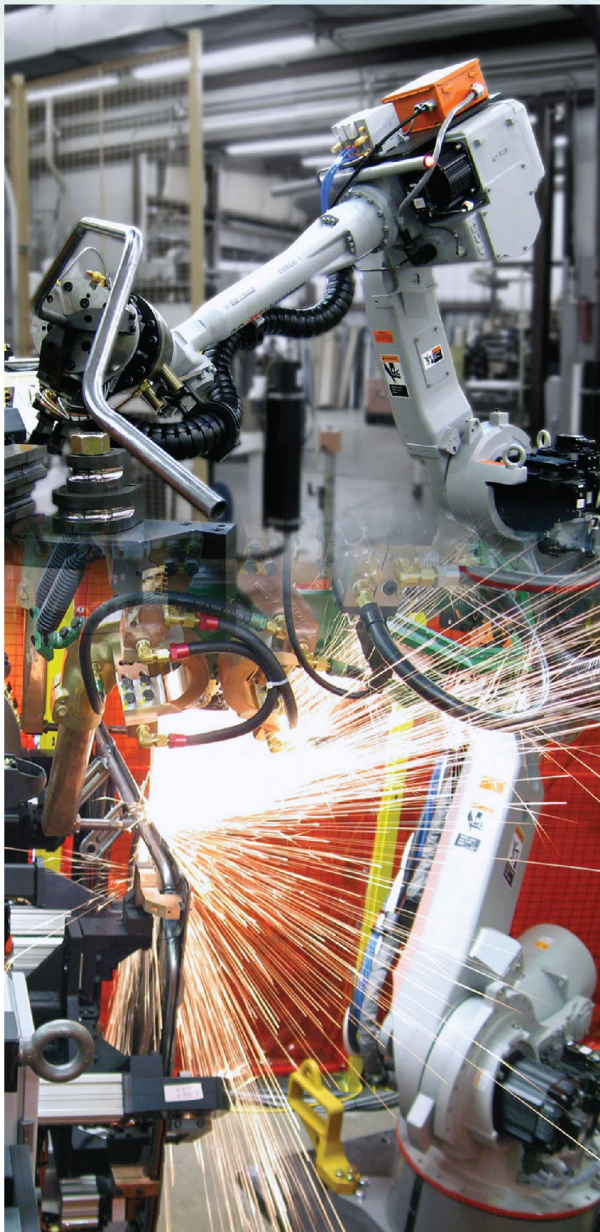



ELECTRIC WAY

ตัวแทนจำหน่ายในประเทศไทย



compomax

บริษัท คอมโพแม็กซ์ จำกัด

16 ซ.เอกมัย4 ถ.สุขุมวิท63 แขวงพระโขนงเหนือ เขตวัฒนา กรุงเทพฯ 10110

โทรศัพท์ : 02-105-0555 โทรสาร : 02-105-0556 -7